

REV.	REVISION RECORD	BY	DATE
0	ORIGIN	LDJ	6.12.2024

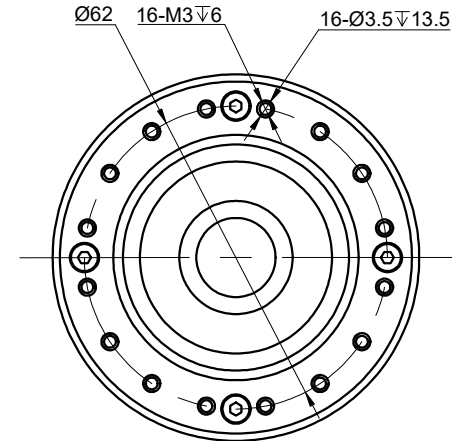
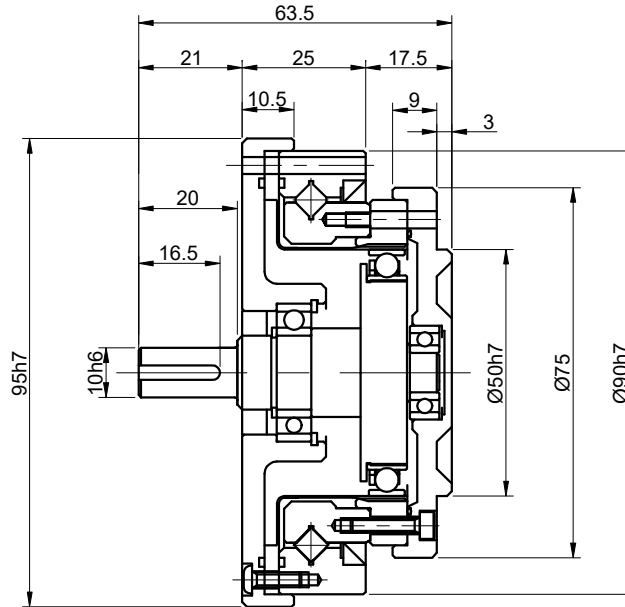
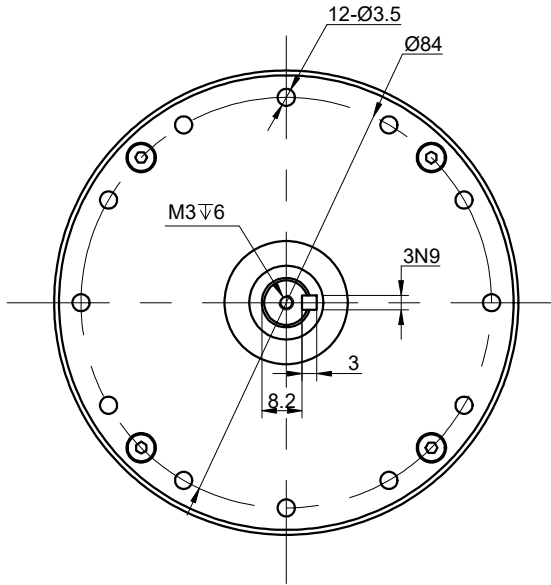

SPECIFICATION	CONNECTION	VALUE
GEAR RATIO		50
BACKLASH@NO-LOAD(arcsec)		<=20
RATED TORQUE(INPUT SPEED 2000RPM)(Nm)[lb-in]		25.00[221.27]
MOMENT PERMISSIBLE TORQUE(Nm)[lb-in]		98.00[867.37]
PEAK START-STOP TORQUE(Nm)[lb-in]		56.00[495.64]
MAXIMUM INPUT SPEED ALLOWED(RPM)		6500
AVERAGE INPUT SPEED ALLOWED(RPM)		3500
WEIGHT(kg)		1.29
LIFE(h)		10000
AMBIENT TEMPERATURE		0°C~40°C[32°F~104°F]

DIMENSIONS ARE IN MILLIMETERS.
TOLERANCES AS BELOW:
DECIMALS ANGLES
X ±0.5 ±2°
X.X ±0.25
X.XX ±0.13

THIRD ANGLE
PROJECTION



SIGNATURE

DATE

DRN

LDJ

6.12.2024

APVD

HW

6.12.2024

STEPPERONLINE®

HARMONIC REDUCER

HHT-20-50-IV-D10