

MODEL NO.	24HS40-5004D-E1000	DWG NO.	A1423
-----------	--------------------	---------	-------

CUSTOMER'S MODEL: NO MODEL
END COVER COLOR: BLACK

REV.	REVISION RECORD	BY	DATE
0	ORIGIN	ZPJ	5.20.2024

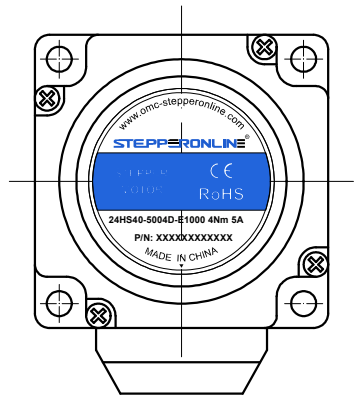
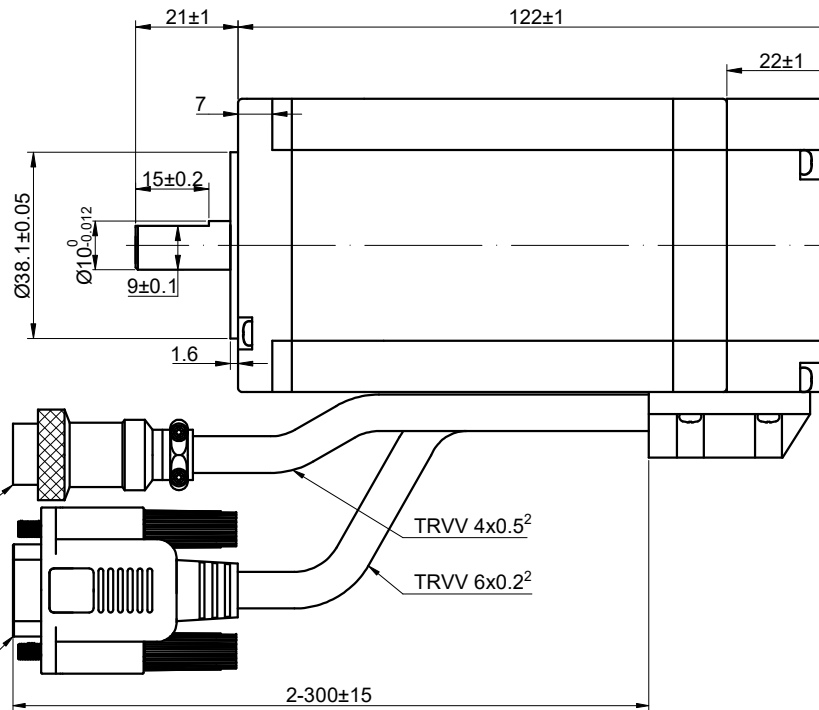
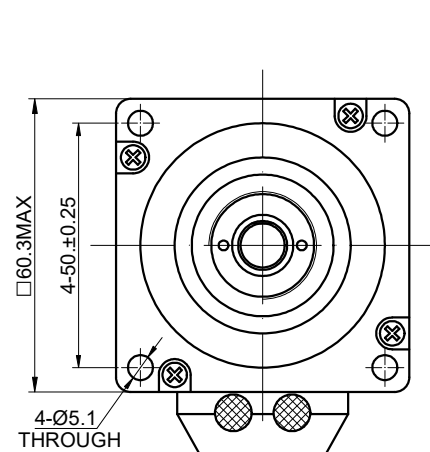

P/N: XXXXXXXXXXXX
YEAR
MONTH
DATE
MOTOR NUMBER

COMMENT:
1.TMBF 6000h OR MORE @ 24V/300RPM
2.INSULATION RESISTANCE
(NORMAL TEMPERATURE AND HUMIDITY): 100 Mohm
3.DIELECTRIC STRENGTH 500VAC FOR 1MIN.(BETWEEN THE MOTOR COILS AND THE MOTOR CASE)

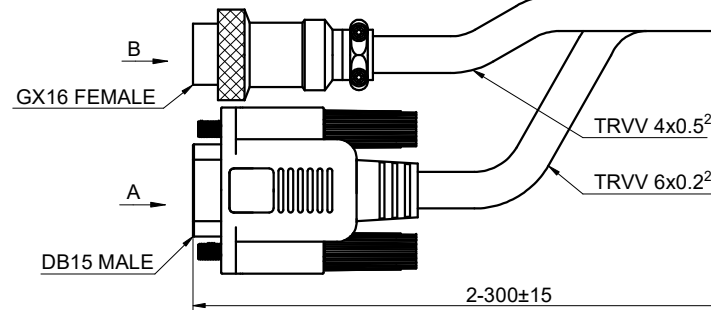

CONNECTION	BIPOLAR
SPECIFICATION	
AMPS/PHASE	5.00
RESISTANCE/PHASE(Ohms)@25°C	0.60±10%
INDUCTANCE/PHASE(mH)@1KHz	2.60±20%
HOLDING TORQUE(Nm)[lb-in]	4.00 [35.43]
STEP ANGLE(°)	1.80
STEP ACCURACY(NON-ACCUM)	±5.00%
ROTOR INERTIA(g-cm²)	1080
DETENT TORQUE(g-cm)	1600
AMBIENT TEMPERATURE	-10°C~50°C[14°F~122°F]
INSULATION CLASS	B 130°C[266°F]
TEMPERATURE RISE	MAX.80°C

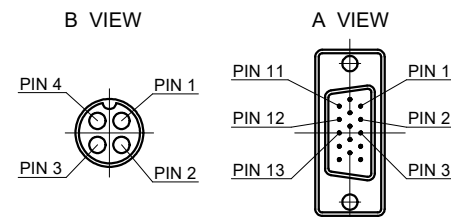

ENCODER RESOLUTION:1000PPR(4000CPR)						
15-PIN DB MALE PLUG	1	2	3	11	12	13
DESCRIPTION	EA+	VCC	GND	EB+	EB-	EA-

MOTOR CONNECTION		
GX16 PIN NO	BIPOLAR	WINDING
1	A+	
2	A-	
3	B+	
4	B-	

FULL STEP 2 PHASE-Ex.,WHEN FACING MOUNTING END (X)						CCW	CW	DIMENSIONS ARE IN MILLIMETERS.	
STEP	A+	B+	A-	B-				TOLERANCES AS BELOW:	ANGLES
1	+	+	-	-				X ±0.5	±2°
2	-	+	+	-				X.X ±0.25	
3	-	-	+	+				X.XX ±0.13	
4	+	-	-	+					

THIS DOCUMENT SHALL NOT BE REPRODUCED
NOR SHALL THE INFORMATION CONTAINED
HEREIN BE USED BY OR DISCLOSED TO
OTHERS UNLESS EXPRESSLY AUTHORIZED IN
BY WRITING STEPPERONLINE.

SIGNATURE		DATE
DRN	ZPJ	5.20.2024
APVD	SY	5.20.2024

STEPPERONLINE®									
STEPPER MOTOR									
24HS40-5004D-E1000									
REV.	0	SCALE	2:3	DWG NO.	A1423				