

↑
B

B VIEW BOTTOM OF SHELL

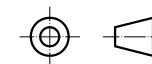
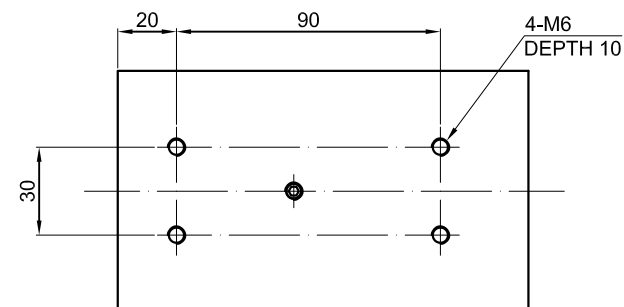

SPECIFICATION	VALUE
POWER (Kw)	1.5
VOLTAGE (VAC)	110
RATED CURRENT (A)	13.6
MAXIMUM SPEED (RPM)	24000
FREQUENCY (Hz)	400
NUT MODEL	ER20
COLLET (mm)	Ø6
COOLING	AIR COOLED
MATERIAL	STAINLESS STEEL
LUBRICATION	GREASE
WEIGHT (Kg) [lb]	6.15 [13.56]

STEPPERONLINE®

mm	APVD		7.13.2022
UNIT	CHKD		
3:1	DRN		
SCALE	SIGNATURE	DATE	

SPINDLE MOTOR

GDZ93×82-1.5A4