

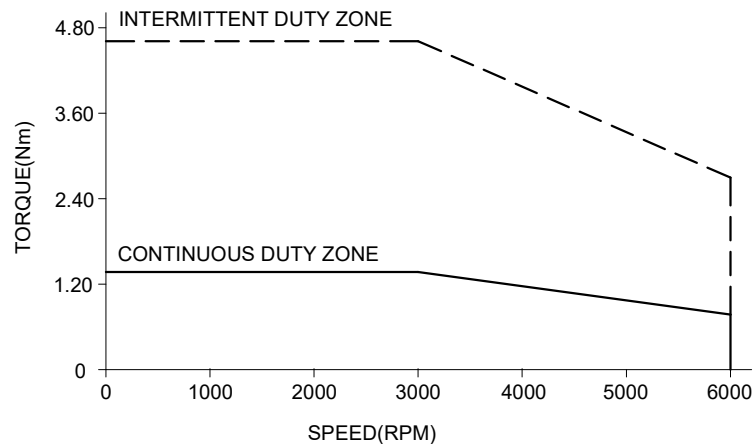

SPEED - TORQUE CURVE

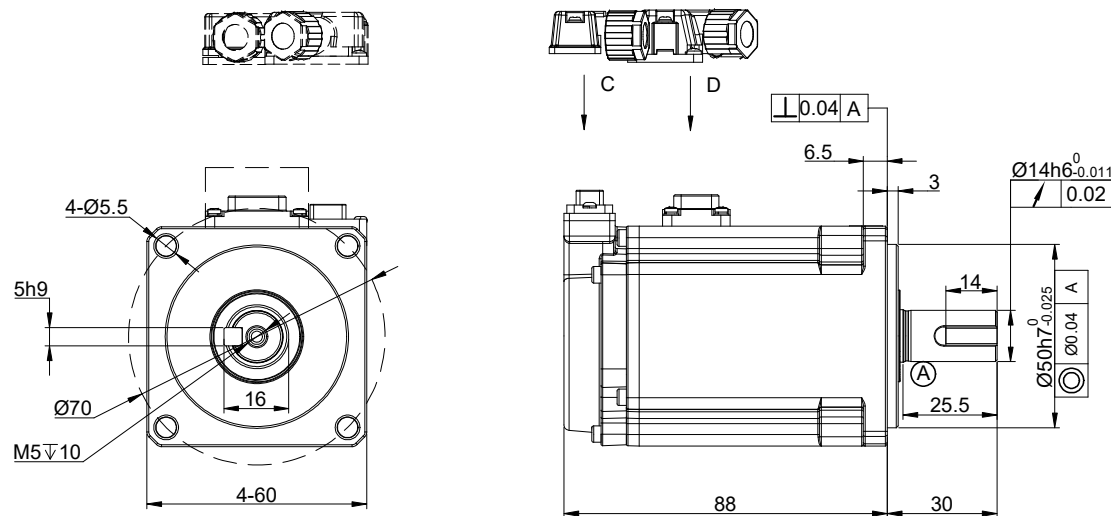

SPECIFICATION	VALUE
RATED VOLTAGE(VAC)	220
RATED POWER(W)	400
RATED TORQUE(Nm)	1.27
PEAK TORQUE(Nm)	4.45
RATED SPEED(RPM)	3000
PEAK SPEED(RPM)	6000
RATED CURRENT(Amp)	2.51
PEAK CURRENT(Amp)	8.78
TORQUE CONST(Nm/Amp)	0.51
BACK EMF CONST(V/KRPM)	33.29
RESISTANCE(Ω)	1.83
INDUCTANCE(mH)	5.60
INERTIA(Kg•m <sup>2</sup> •10 <sup>-4</sup> )	0.59
POLES	10
ENCODER TYPE	17bit magnetic
IP RATING	IP67
WEIGHT(KG)	-



WIRING DETAILS OF POWER CABLE CONNECTOR							
D	PIN No.	1	2	3	4	--	--
	DESCRIPTION	V	U	W	PE	--	--
	COLOR	BLK	WHT	RED	YEL/GRN	--	--

	WIRING DETAILS OF ENCODER CABLE CONNECTOR							
	PIN No.	1	2	3	4	5	6	7
	DESCRIPTION	5V	0V	-	-	PS+	PS-	PE
	-	-	-	-	-	-	-	-
	-	-	-	-	-	-	-	-

THE PART NUMBER OF CABLE FOR A6M60-400H2A1-M17 MOTOR		
POWER CABLE	AS7-C-PWR075-3.0	3m
ENCODER CABLE	AS7-C-ENC075-3.0	3m

**STEPPERONLINE®**

	APVD	HW	8.6.2024
	CHKD		
2:1	DRN	LDJ	8.2.2024
SCALE	SIGNATURE	DATE	

**AC SERVO MOTOR**

**A6M60-400H2A1-M17**