

| | | | |
|-----------|---------------|---------|-------|
| MODEL NO. | 42BLS40-24-01 | DWG NO. | A1602 |
|-----------|---------------|---------|-------|

CUSTOMER'S MODEL: NO MODEL
END COVER COLOR: GRAY

| REV. | REVISION RECORD | BY | DATE |
|------|-----------------|-----|----------|
| 0 | ORIGIN | MYX | 6.7.2024 |
| | | | |

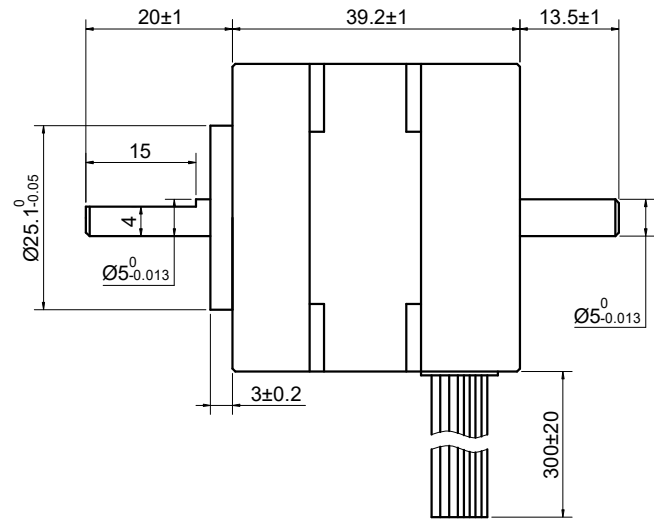
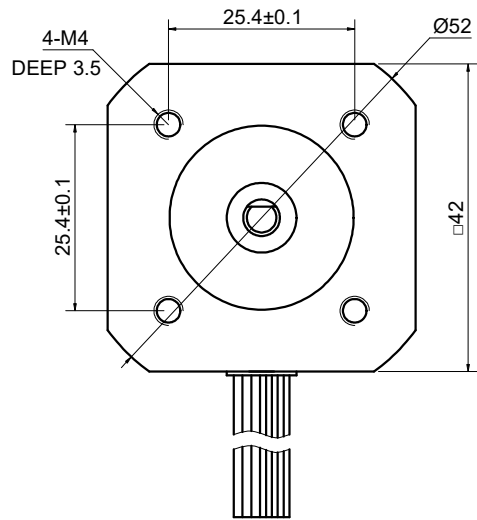

| SPECIFICATION | VALUE |
|-----------------------------|------------------------|
| NO. of PHASES | 3 |
| NO. of POLES | 8 |
| RESISTANCE/PHASE(Ohms)@25°C | 1.9±10% |
| INDUCTANCE/PHASE(mH)@1KHz | 2.55±25% |
| RATED VOLTAGE(V) | 24 |
| RATED TORQUE(mN.m) | 63 |
| RATED POWER(W) | 26 |
| RATED SPEED(RPM) | 4000±10% |
| RATED CURRENT(A) | 1.8±10% |
| NO LOAD SPEED(RPM) | 6700 |
| NO LOAD CURRENT(A) | 0.2 |
| SENSOR | HALL SENSOR |
| BEARING TYPE | NMB BALL BEARING, C3 |
| AMBIENT TEMPERATURE | -10°C~50°C[14°F~122°F] |
| INSULATION CLASS | B 130°C[266°F] |
| TEMPERATURE RISE | MAX.80°C |

| | | |
|--|--|------|
| COMMENT: 1.DYNAMIC AXIAL LOAD: 10N MAX 2.DYNAMIC RADIAL LOAD @ SHAFT LENGTH 20mm: 20N MAX 3.INSULATION RESISTANCE (NORMAL TEMPERATURE AND HUMIDITY): 100 Mohm 4.DIELECTRIC STRENGTH: AC600V CUT OFF CURRENT 5mA FOR 1S | DIMENSIONS ARE IN MILLIMETERS. TOLERANCES AS BELOW: DECIMALS ANGLES X ±0.5 ±2° X.X ±0.25 X.XX ±0.13 | |
| | THIRD ANGLE PROJECTION | |
| | SIGNATURE | DATE |
| THIS DOCUMENT SHALL NOT BE REPRODUCED NOR SHALL THE INFORMATION CONTAINED HEREIN BE USED BY OR DISCLOSED TO OTHERS UNLESS EXPRESSLY AUTHORIZED IN BY WRITING STEPPERONLINE. | DRN | MYX |
| | APVD | ZPJ |

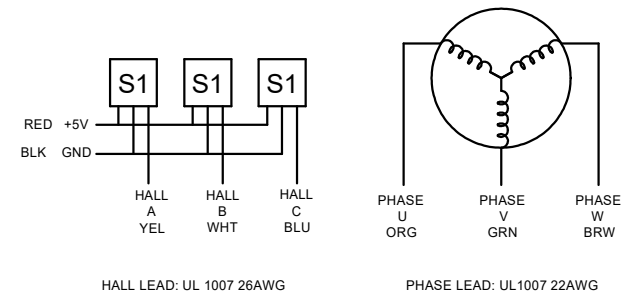

| | | | | | | | | | |
|--|---|-------|-----|---------|-------|--|--|--|--|
| <div> <div>STEPPERONLINE®</div> <div>STEPPER MOTOR</div> <div>42BLS40-24-01</div> </div> | | | | | | | | | |
| REV. | 0 | SCALE | 1:1 | DWG NO. | A1602 | | | | |